

ELMER ENTERPRISE CO.,LTD.

Phone 886-2-22596278 Fax 886-2-22574908
 e-mail:elmermc@ms9.hinet.net

REVISIONS

REV	SYM	DRAFTER	CHECKER	DATE
△		T.S.LII	W.H.HSU	08/19/02
△		T.S.LII	W.H.HSU	03/10/03
△		T.S.LII	W.H.HSU	07/16/03

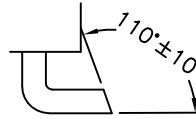
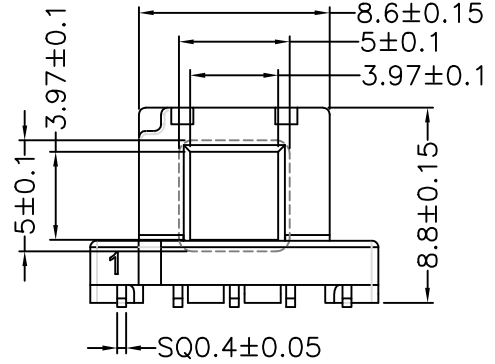
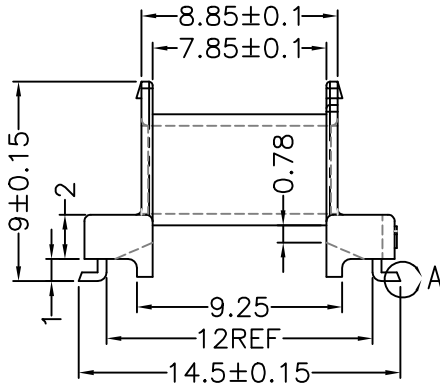
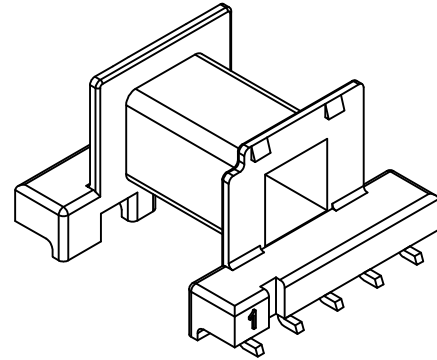
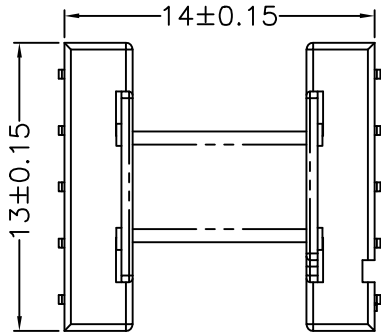

DETAIL : A
(PATENTED)

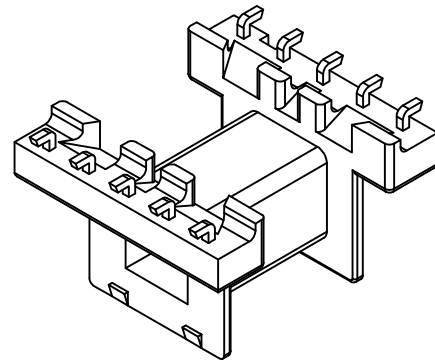
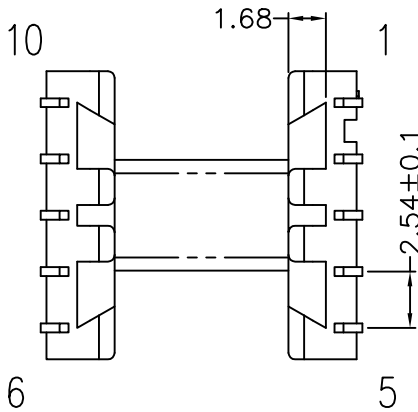

PART NO. EF-12.6-10P-L-2.54-D-1

DWG NO. TBI-105-01041.104

TBI NO.	MATERIAL (BOBBIN)	MATERIAL (TERMINAL)	TERMINAL (PLATING)
105-01041.104	PM-9630	CP WIRE	Au

MATERIAL (BOBBIN) PM-9630

MATERIAL (TERMINAL) CP WIRE

TERMINAL (PLATING) Au

PART NO.

REV

MODE NO

PIN LOCATION

Finish:

- 1-1. Immersion gold on terminal.
Thickness gold 0.075 μ m (3 μ inches) min,
Base nickel 0.625 μ m (25 μ inches) min.
- 1-2. Immersion Sn on terminal.
Terminal:Sn plating,100, 5 μ m (200 μ inches) min
Base nickel 0.625 μ m (25 μ inches) min.
- 1-3. Immersion Sn/Pb on terminal.
Terminal:Sn/Pb plating,90/10, 5 μ m (200 μ inches) min
Base nickel 0.625 μ m (25 μ inches) min. (for pin GW type)
2. Coplanarity deviation: 0.004 inches max.

TOLERANCE

.X \pm 0.15
.XX \pm 0.10
.XXX \pm 0.05

UNIT

m/m

SCALE

3 : 1

REV

4